

**This electronic collection of documents is provided
for the convenience of the user
and is Not a Certified Document –**

**The documents contained herein were originally issued
and sealed by the individuals whose names and license
numbers appear on each page, on the dates appearing
with their signature on that page.**

**This file or an individual page
shall not be considered a certified document.**

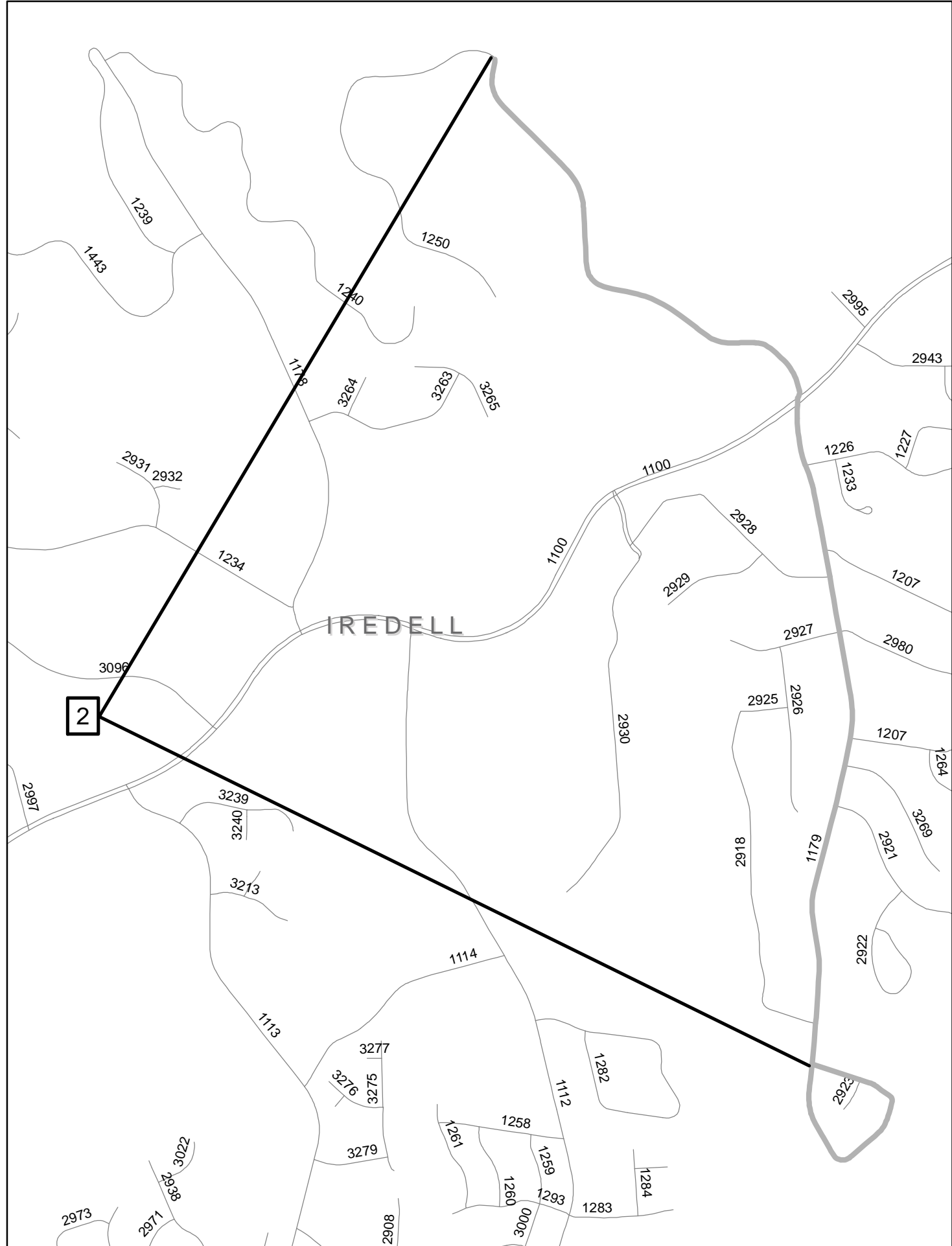
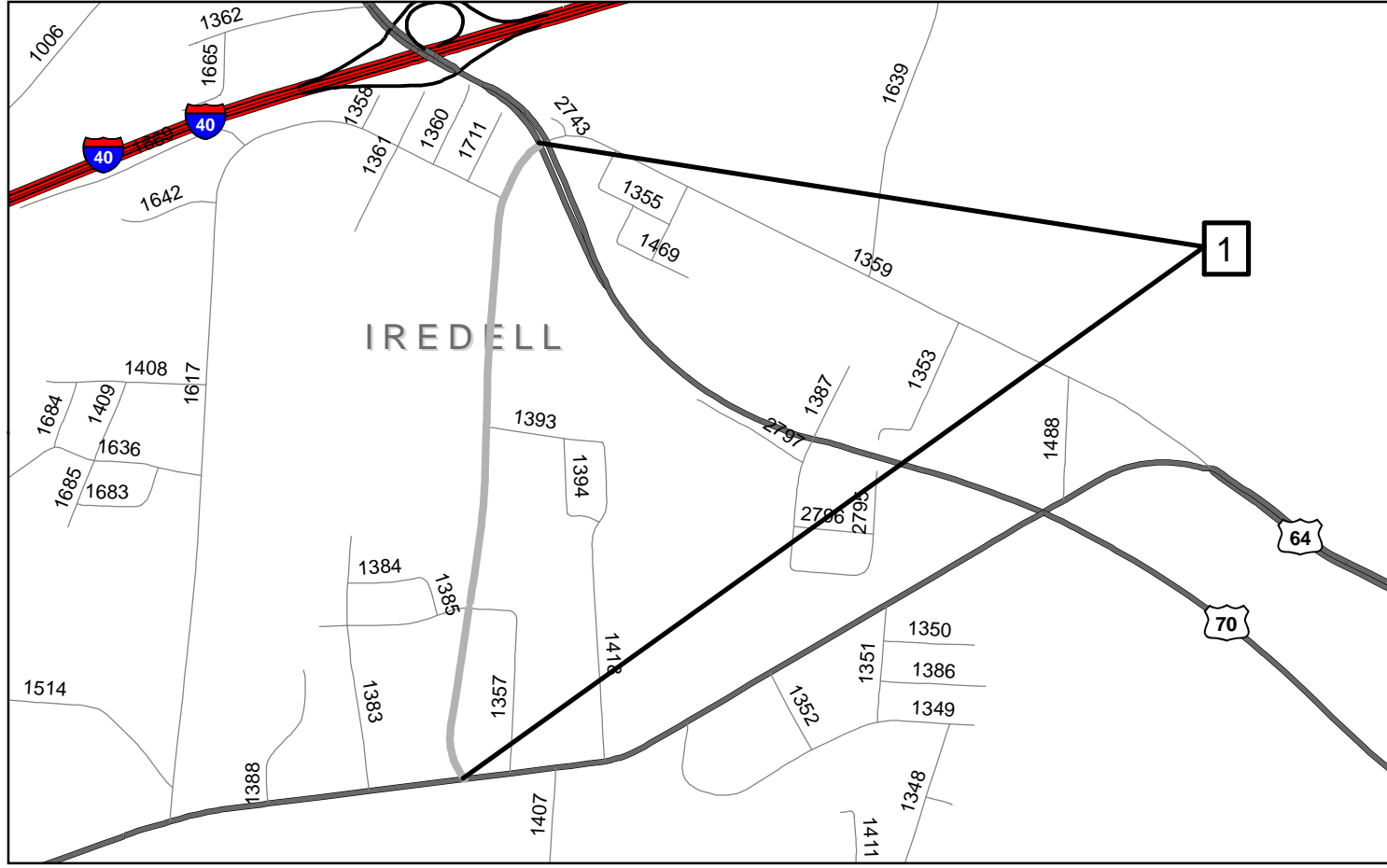

PROJ. REFERENCE NO. IREDELL COUNTY	SHEET NO. 3	TOTAL SHEETS
STATE PROJ. NO. 49861.3.1	F.A. PROJ. NO.	DESCRIPTION SECONDARY RESURFACING
HL-0037		

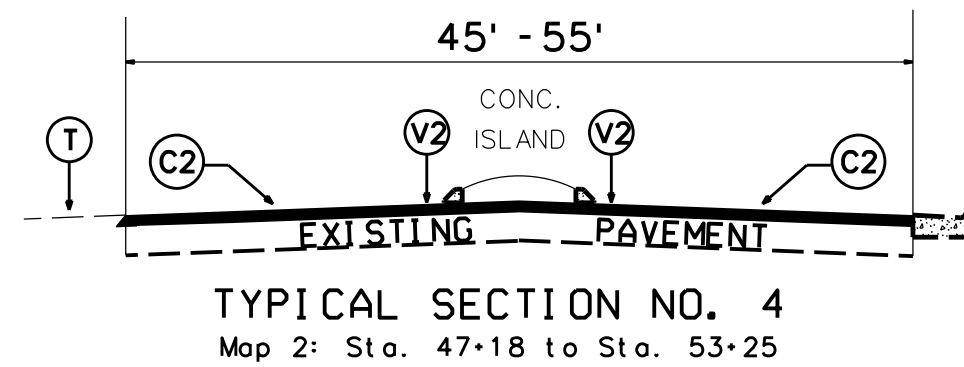
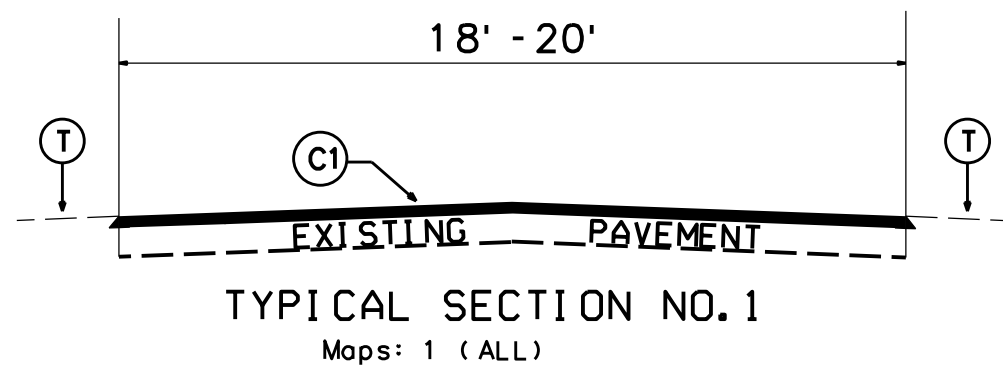

** Note: No work on Map 2 between Ends of Conc. Islands (53+25 to 55+50) at Brawley Sch. Rd. Intersection.

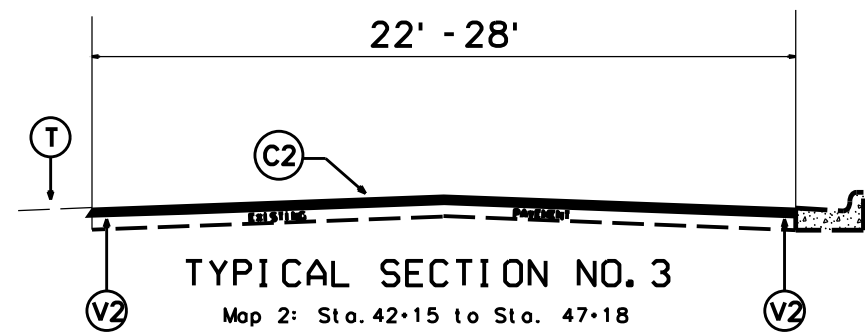
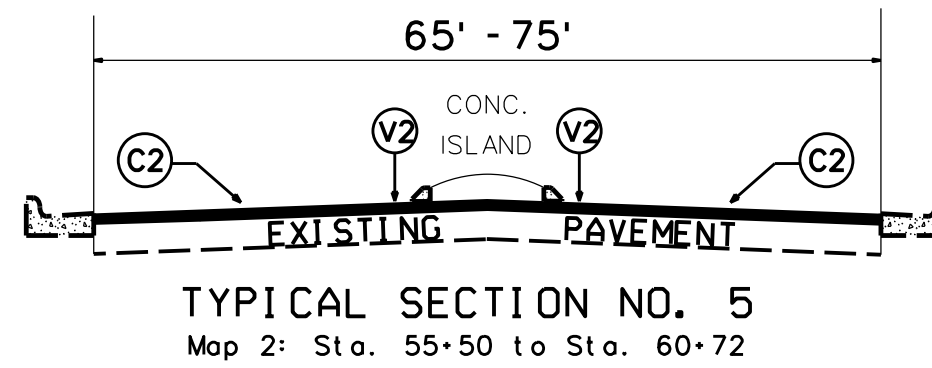
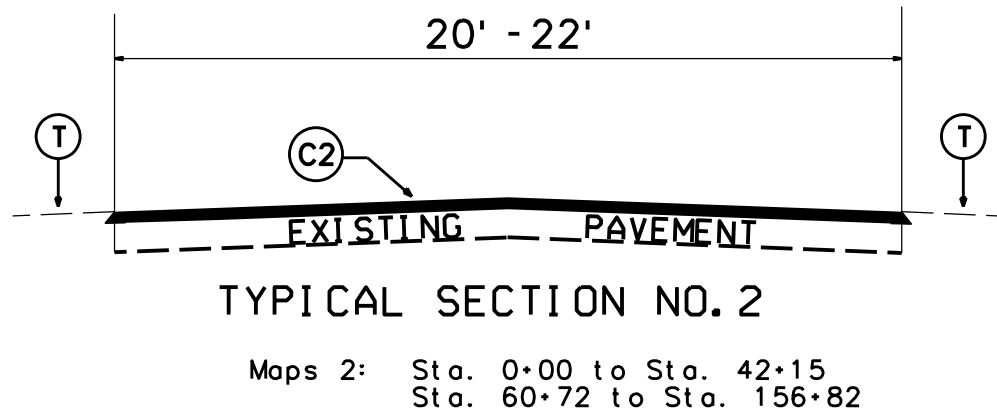

PAVEMENT SCHEDULE	
C1	PROP. APPROX. 1.0" ASPHALT CONCRETE SURFACE COURSE, TYPE S9.5B, AT AN AVERAGE RATE OF 110 LBS. PER SQ. YD.
C2	PROP. APPROX. 1.5" ASPHALT CONCRETE SURFACE COURSE, TYPE S9.5C, AT AN AVERAGE RATE OF 168 LBS. PER SQ. YD.
T	AGGREGATE SHOULDER BORROW (SHOULDER RECONSTRUCTION)
V2	MILL EXISTING ASPHALT PAVEMENT APPROX. 1.5" IN DEPTH

2023 Additional Resurfacing
Typical Sections
Iredell County

PROJ. REFERENCE NO.	SHEET NO.	TOTAL SHEETS
IREDELL COUNTY	4	
STATE PROJ. NO.	F. A. PROJ. NO.	DESCRIPTION
49861.3.1		SECONDARY RESURFACING
HL-0037		

**DETAIL A
PATCHING EXISTING PAVEMENT**

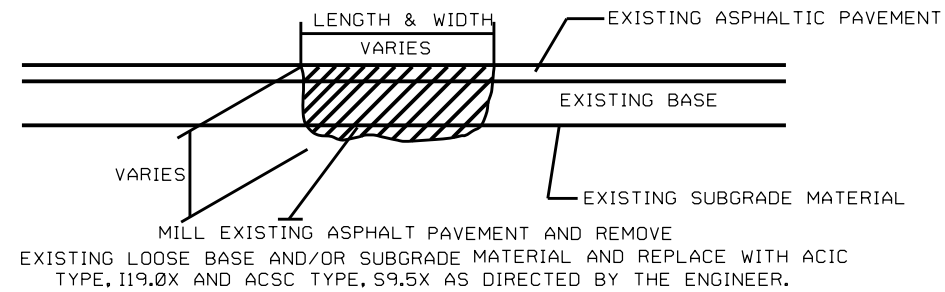

**DETAIL C
MILLING BRIDGE APPROACHES**



**DETAIL B
ASPHALT CONCRETE SURFACE COURSE
TYPE S9.5B & S9.5C (LEVELING COURSE)**

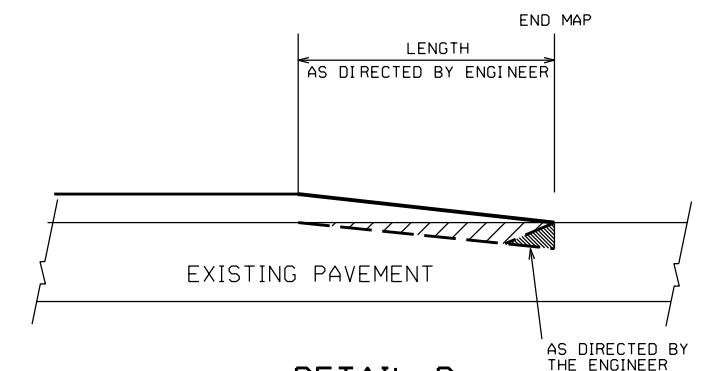
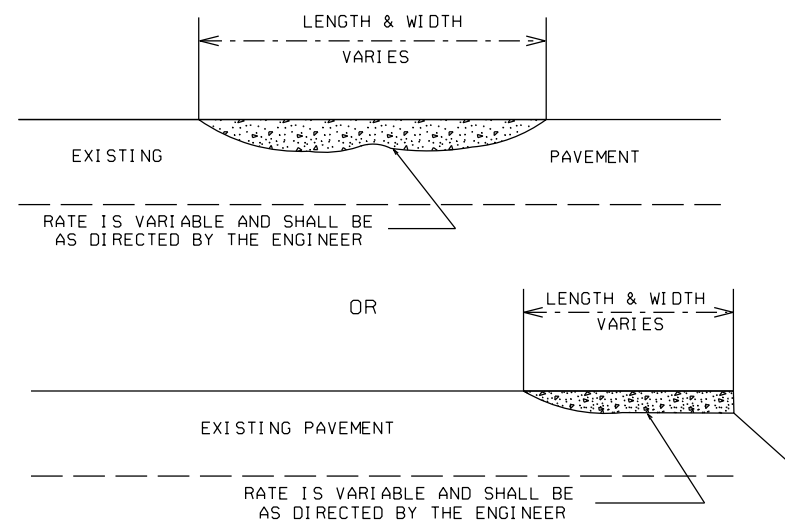

**DETAIL D
TIE-IN (INCIDENTAL) MILLING DETAIL**

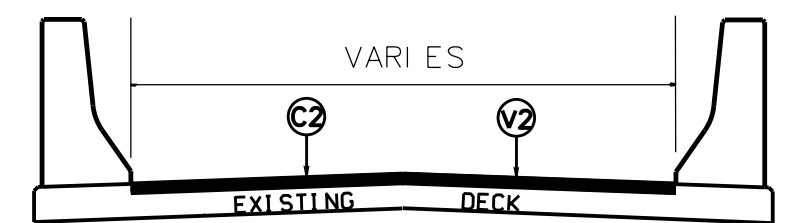

**ASPHALT BRIDGE SECTION
Use for all asphalt bridges**

**DETAIL E
BRIDGE HALF TYPICAL SECTION**

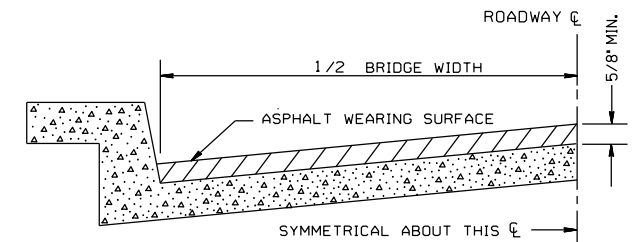

FOR BRIDGES WITH FLOOR DRAINS, CARE SHALL BE EXERCISED IN PLACING THE WEARING SURFACE AROUND FLOOR DRAINS SO AS NOT TO HINDER EFFECTIVE DRAINAGE. ALL DRAINS SHALL BE LEFT OPEN.

THE PROPOSED WEARING SURFACE SHALL VARY IN THICKNESS AS NECESSARY TO PROVIDE A SMOOTH RIDING SURFACE. A THICKNESS OF NOT LESS THAN 5/8" SHALL BE PROVIDED. THE MAXIMUM THICKNESS SHALL PREFERABLY BE 1-1/2" UNLESS IT IS IMPRACTICAL TO PROVIDE A SMOOTH RIDING SURFACE OTHERWISE.

NOTES

ALL UNPAVED S.R. ROADS TO BE SURFACED 50' FROM EDGE OF PAVEMENT OF MAIN PROJECT.
 ALL PAVED S.R. ROADS TO BE RESURFACED TO THE ENDS OF THE RADII, OR AS DIRECTED BY THE ENGINEER.
 EDGES, PAVEMENT WIDENING, INTERSECTIONS AND BRIDGE FLARES ARE INCLUDED IN THE TABLE OF QUANTITIES.
 SHOULDERS AND DITCHES ARE TO BE CONSTRUCTED BY OTHERS UNLESS OTHERWISE NOTED.
 BRIDGES TO BE RESURFACED AT LOCATIONS AND TO DEPTH AS DIRECTED BY THE ENGINEER.

PAVEMENT SCHEDULE	
C1	PROP. APPROX. 1.0" ASPHALT CONCRETE SURFACE COURSE, TYPE S9.5B, AT AN AVERAGE RATE OF 110 LBS. PER SQ. YD.
C2	PROP. APPROX. 1.5" ASPHALT CONCRETE SURFACE COURSE, TYPE S9.5C, AT AN AVERAGE RATE OF 168 LBS. PER SQ. YD.
T	AGGREGATE SHOULDER BORROW (SHOULDER RECONSTRUCTION)
V2	MILL EXISTING ASPHALT PAVEMENT APPROX. 1.5" IN DEPTH

- NOTES:
- 1) DETAIL DOES NOT APPLY TO OGAFc AND ULTRA-THIN BONDED WEARING COURSE.
 - 2) BACKFILL SHOULDER WITH APPROVED MATERIAL.
 - 3) THE SHOULDER WEDGE DEVICE MAY BE DISENGAGED AT PAVED DRIVEWAYS AND SIDE STREETS.

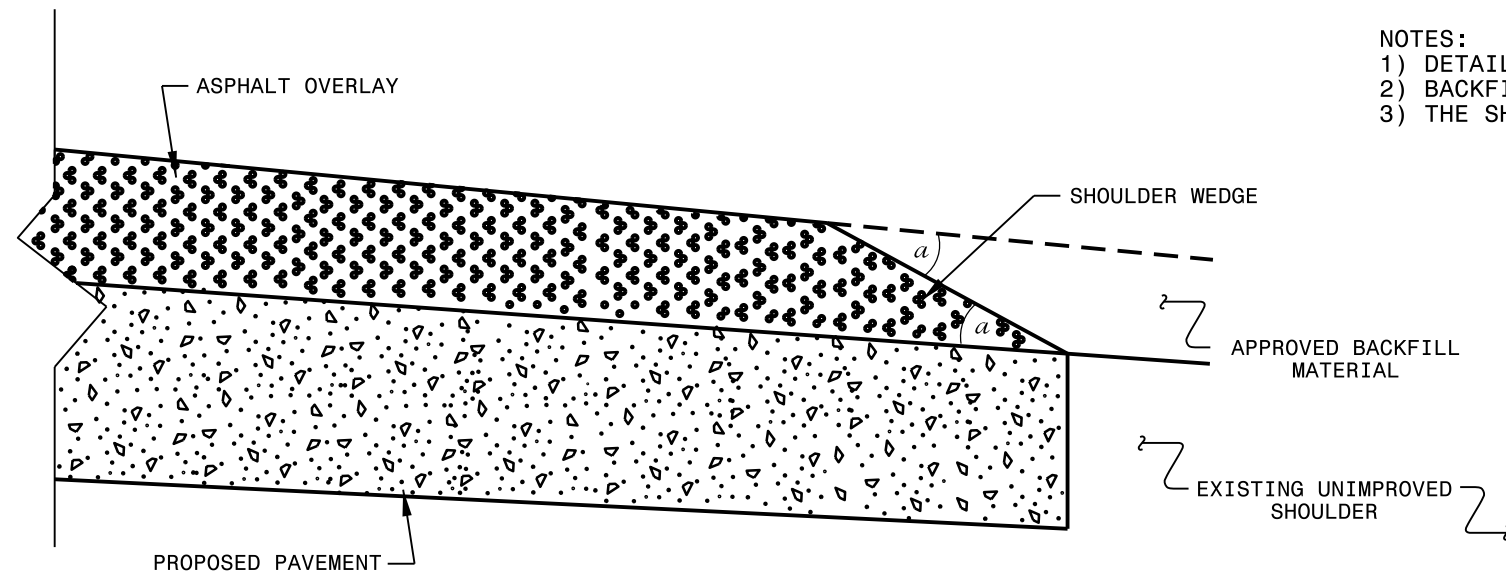

SHOULDER WEDGE DETAIL
 (Resurfacing Projects w/ Widening or
 with Existing Paved Shoulder having no dropoffs)

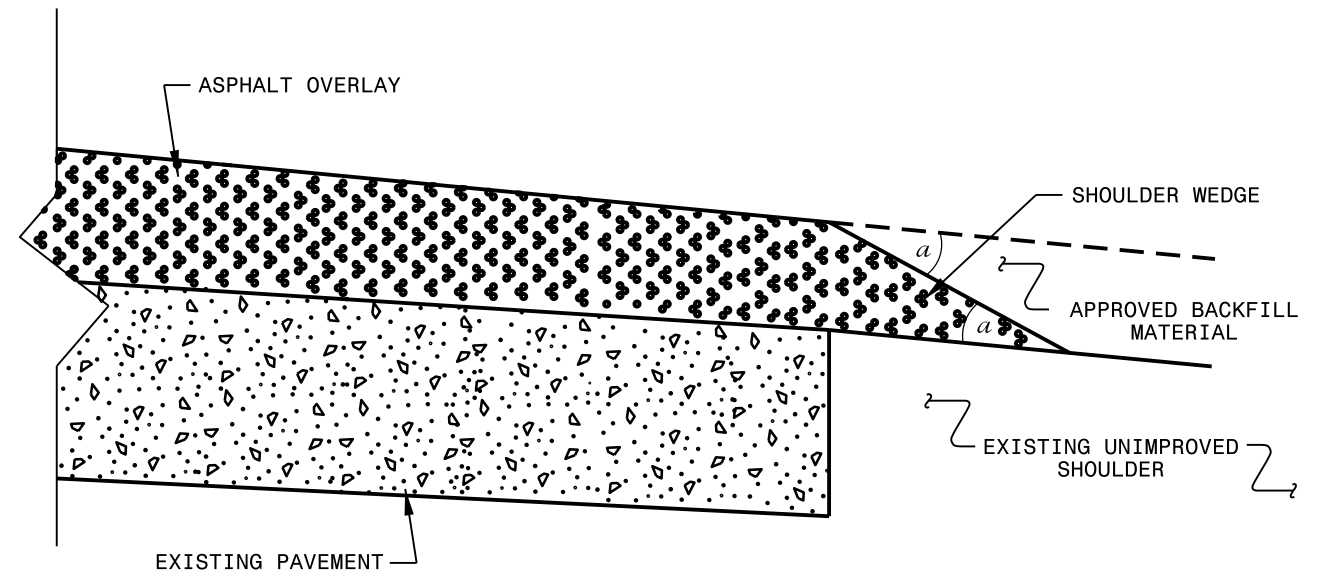

SHOULDER WEDGE DETAIL
 (Resurfacing Projects w/ NO Widening)

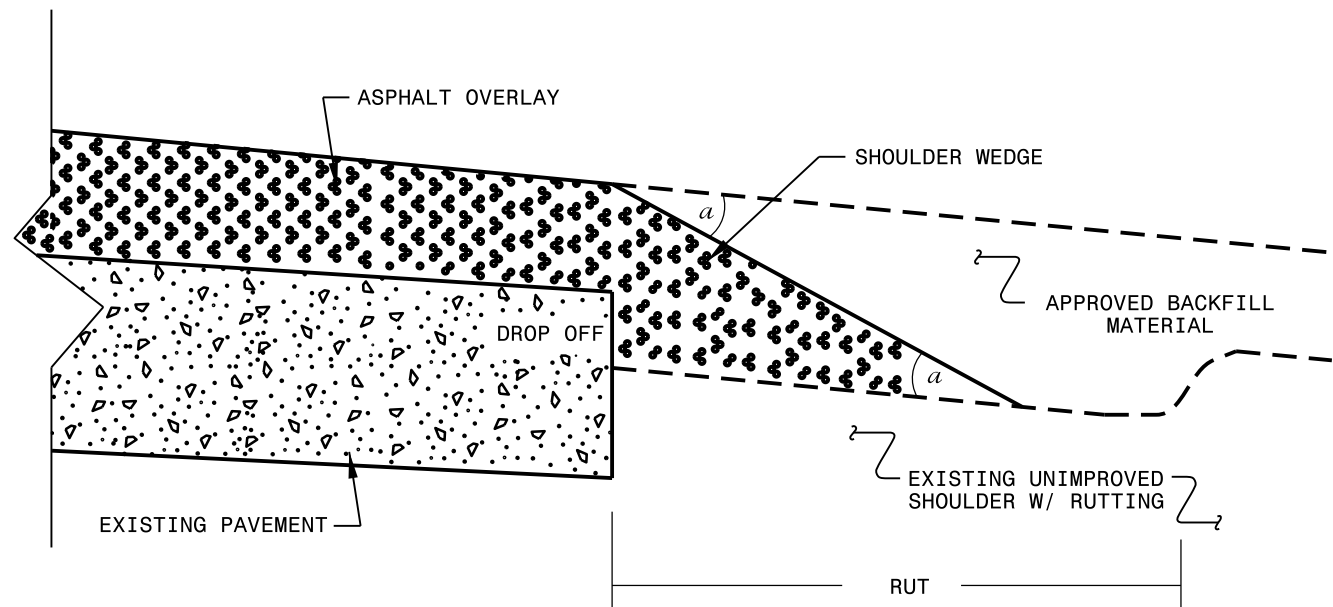

SHOULDER WEDGE DETAIL
 (Resurfacing Adjacent to
 Rutted Shoulder)

- SHOULDER WEDGE ANGLE = 30°

CONTRACT STANDARDS AND DEVELOPMENT UNIT			
Office 919-707-6950		FAX 919-250-4119	
SHOULDER WEDGE DETAILS			
ORIGINAL BY: T.SPELL	DATE: 7-19-11		
MODIFIED BY:	DATE: 10/16/12		
CHECKED BY:	DATE:		
FILE SPEC.: susr/details/stand/shoulderwedgedetail.dgn			

SYSTEMS DESIGN
 USER NAME

High Speed Detection (≥40 mph)

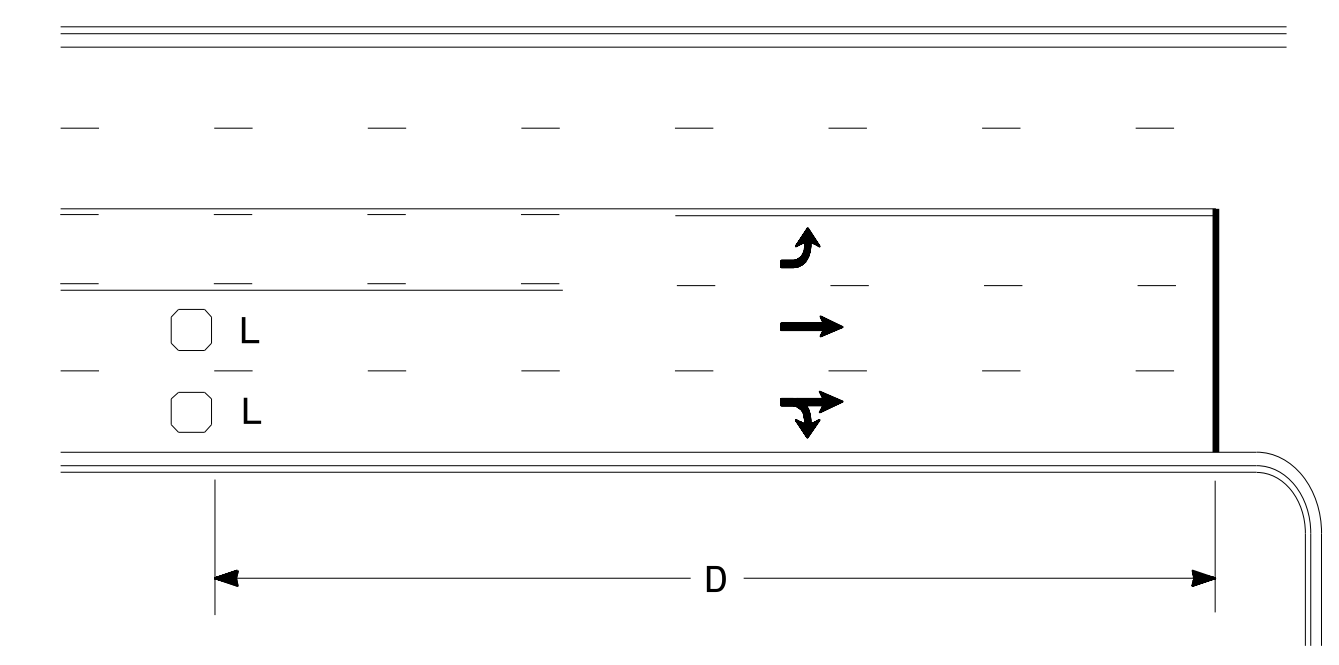

Speed Limit mph	D ft
40	250
45	300
50	355
55	420

L = 6ft X 6ft
Wired in series for TS1
Controllers
Wired separately for TS2,
170, and 2070L Controllers

Volume Density Operation

OR

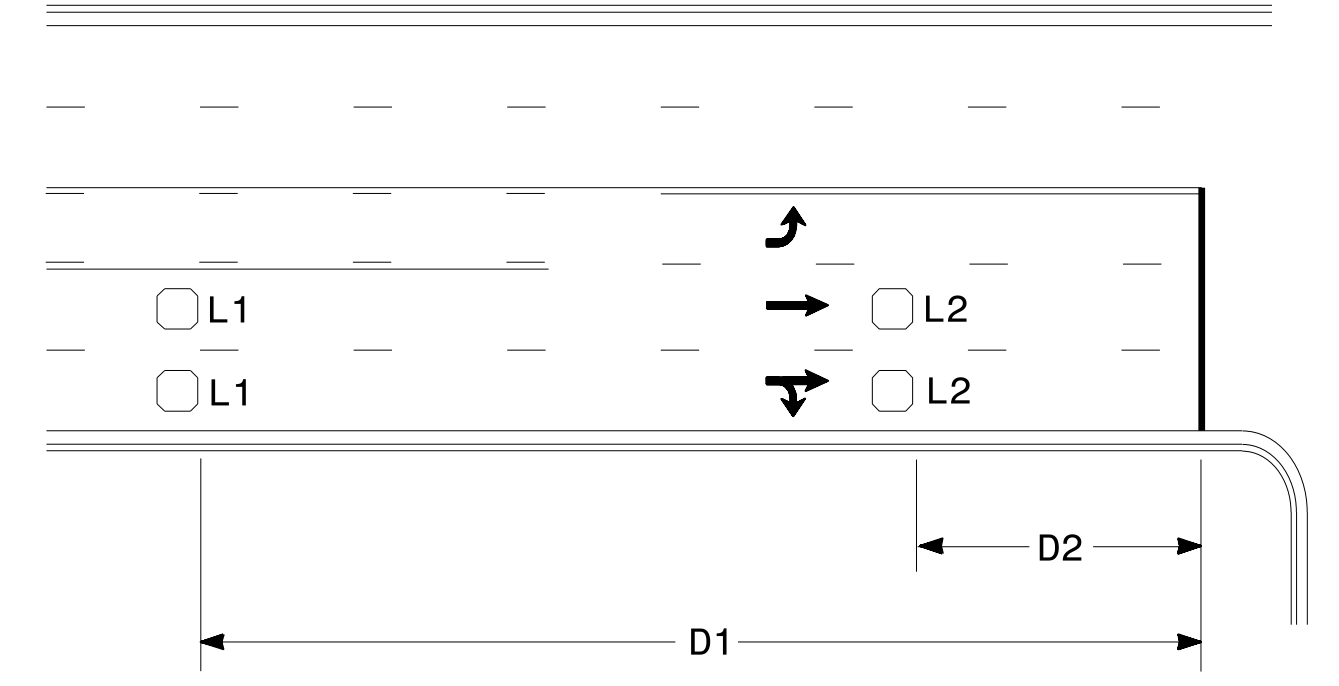

Speed Limit mph	D1 ft	D2 ft
40	250	80
45	300	90
50	355	100
55	420	110

L1 = 6ft X 6ft
Wired in series
L2 = 6ft X 6ft
Wired in series

"Stretch" Operation

Low Speed Detection (≤35 mph)

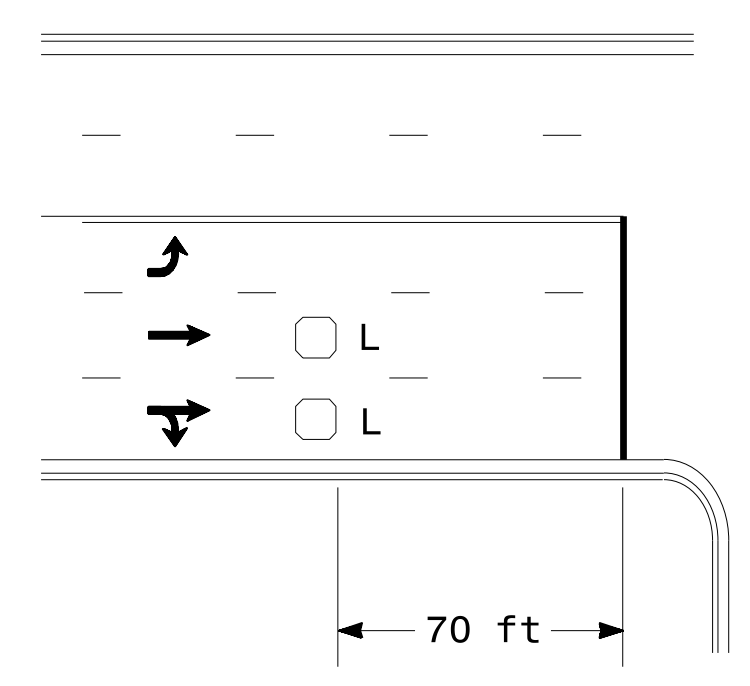

L = 6ft X 6ft
Wired in series

OR

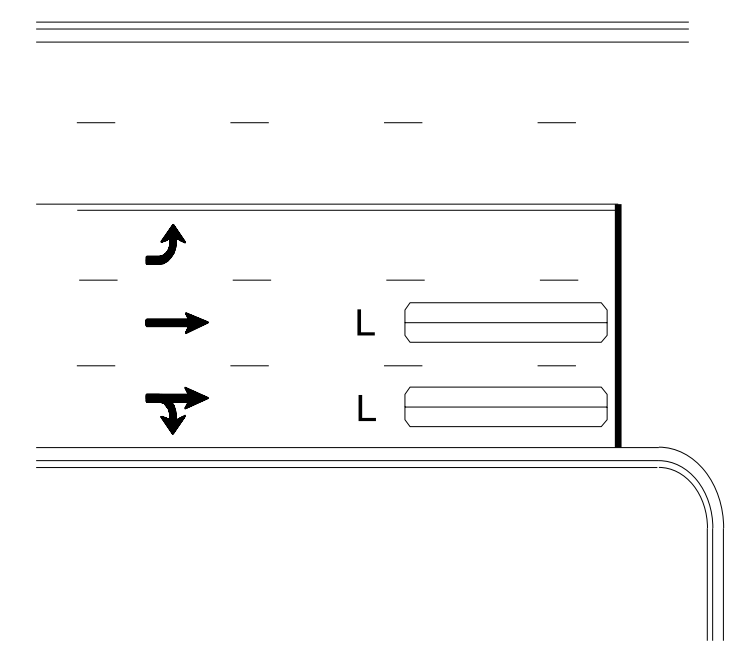

L = 6ft X 40ft
Quadrupole loop, wired separately

Left Turn Lane Detection

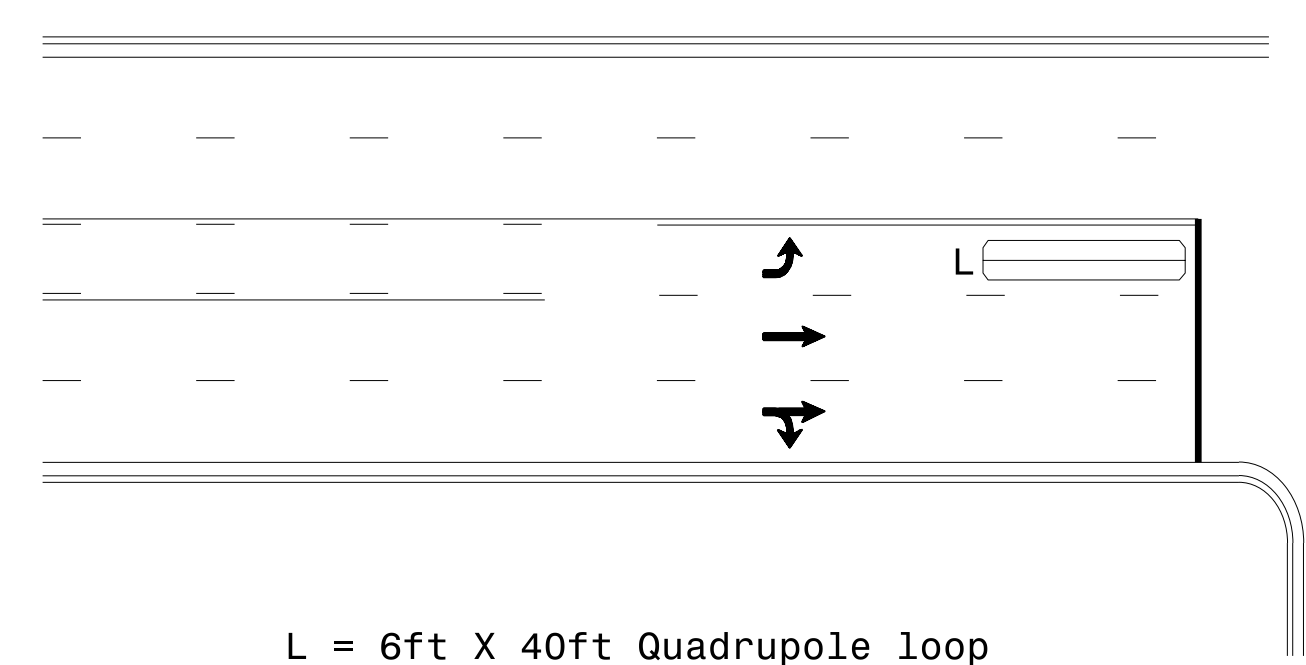

L = 6ft X 40ft Quadrupole loop

Presence Loop Detection

OR

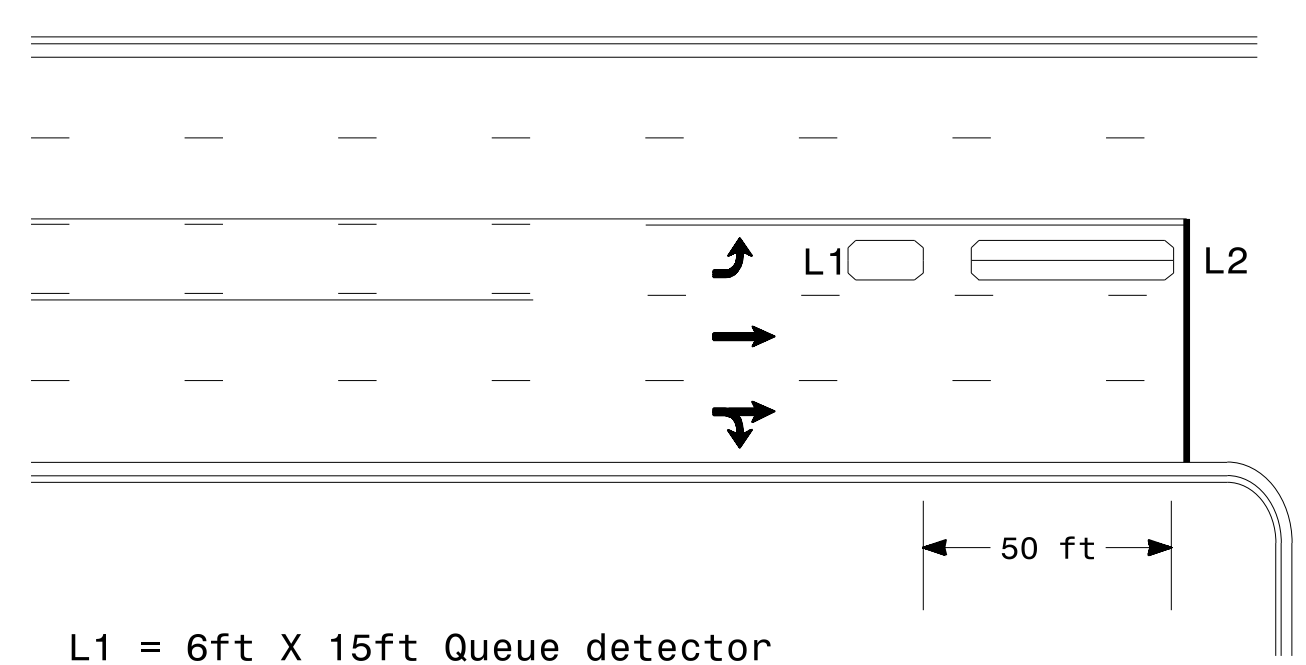

L1 = 6ft X 15ft Queue detector
L2 = 6ft X 40ft Quadrupole loop

Queue Loop Detection

Right Turn Lane Detection

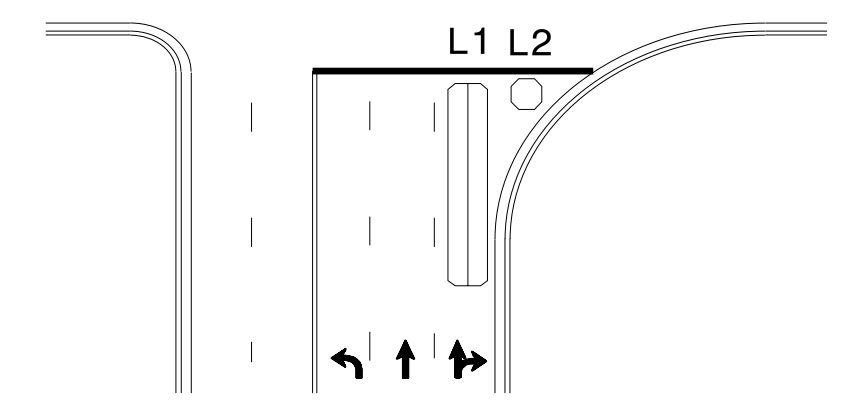

Shared Lane/
Wide Radius Turn

L1 = 6ft X 40ft Quadrupole loop
L2 = 6ft X 6ft [Minimum] Presence loop
Wired separately

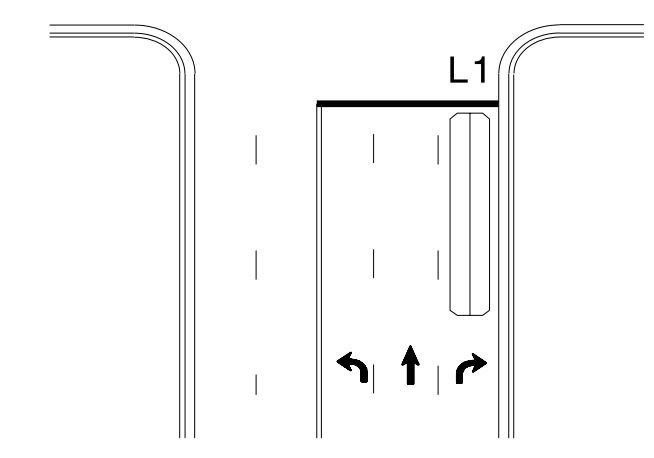

Standard Turn

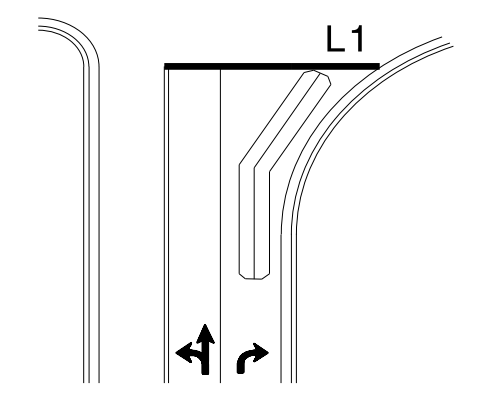

Wide Radius Turn

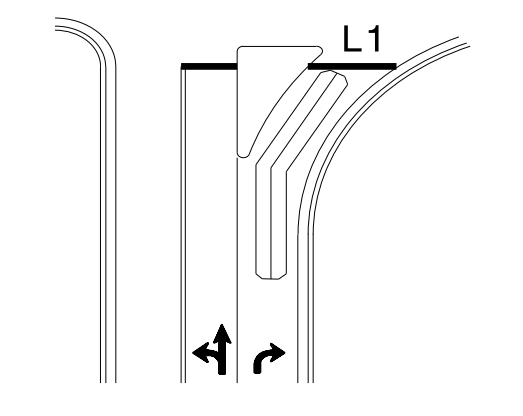

Channelized Turn

Side Street Detection

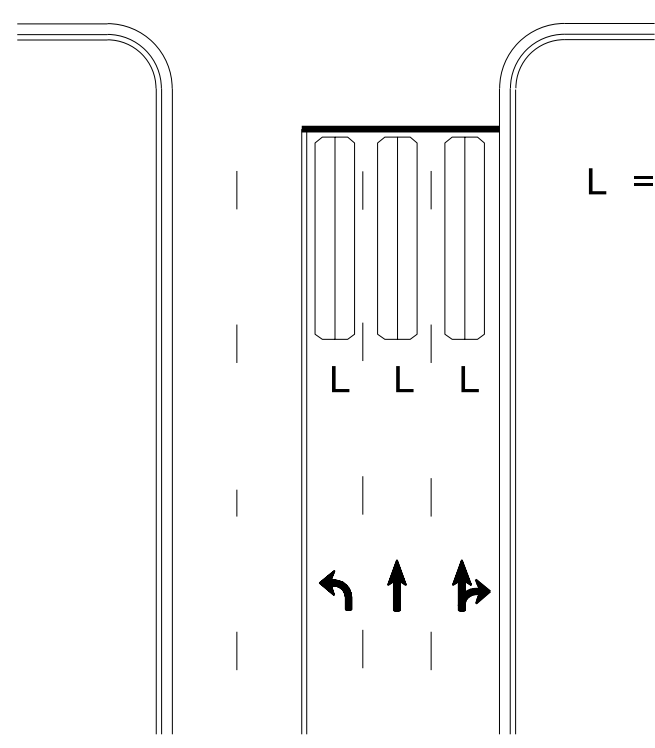

L = 6ft X 40ft
Quadrupole loop
Wired to separate
detectors/channels

Presence Loop Placement at Stop Lines

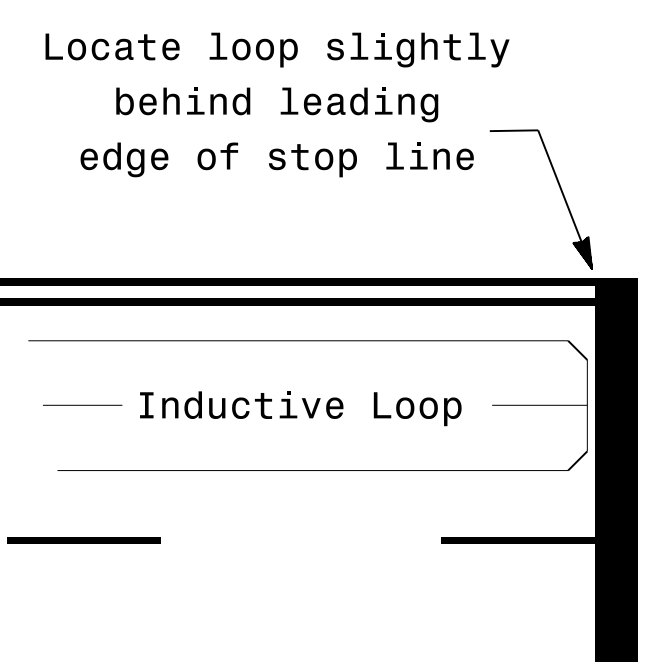

Locate loop slightly
behind leading
edge of stop line

Note:
Loop may be located in advance
of stop line under any of the
following conditions:
1) stop line is greater than 15'
from edge of intersecting
roadway
2) loop detects a permissive or
protected/permissive left turn
3) for an exclusive right turn
lane

Recommended Number of Turns

Single 6' X 6' loop
(when wired separately):

Length of Lead-in ft	Number of Turns
< 250	3
250-375	4
375-525	5
> 525	6

Quadrupole loops: Use 2-4-2 turns
6' X 15' Loops:
Lead-in < 150', use 2 turns
Lead-in > 150', use 3 turns

750 N. Greenfield Pkwy, Garner, NC 27529

Typical Signal Loop Locations

PLAN DATE: January 2015	REVIEWED BY: JPG
PREPARED BY: PLA	REVIEWED BY:
REVISIONS	INIT. DATE

SCALE: N/A

SEAL

1/30/2015

3D:\49861\3.2\15_12\15_12_Signal\Signal Design\Section\Eastern_Region\loop\typical\2015.dgn
 P:\alexander

PROJECT NO.	SHEET NO.	TOTAL NO.
49861.3.1		

SUMMARY OF QUANTITIES

PROJECT NO	COUNTY	MAP NO	ROUTE	DESCRIPTION	TYP NO	LANES	FINAL SURFACE TESTING REQUIRED	WARM MIX ASPHALT REQUIRED	LENGTH	WIDTH	0255000000-E	1220000000-E	1245000000-E	1297000000-E	1330000000-E	1519000000-E	1520000000-E	1523000000-E	1524000000-E	1575000000-E	1704000000-E	2830000000-N	2845000000-N	7324000000-N	7444000000-E	7456000000-E	5255000000-N
											AGGREGATE SHOULDER BORROW	INCIDENTAL STONE BASE	SHOULDER RECONSTRUCTION	1½" MILLING	INCIDENTAL MILLING	SURFACE COURSE, \$9.5B	LEVELING COURSE, \$9.5B	SURFACE COURSE, \$9.5C	LEVELING COURSE, \$9.5C	ASPHALT BINDER FOR PLANT MIX	PATCHING EXISTING PAVEMENT	ADI. OF MANHOLES	ADI. OF METER OR VALVE BOX	JUNCTION BOX (STANDARD SIZE)	INDUCTIVE LOOP	LEAD-IN CABLE	PORTABLE CONSTRUCTION LIGHTING
								MI	FT	TON	TONS	SMI	SY	SY	TONS	TONS	TONS	TONS	TONS	TONS	EA	EA	EA	LF	LF	LS	
49861.3.2	Iredell	1	SR1359 (BRISTOL DRIVE)	FROM NC90/US64 TO US70	1	2	NO	NO	1.14	18-20	380	50	2.28		75	850	550			101	150	1	1	1	324	100	*
49861.3.2	Iredell	2	SR1179 (OAK TREE/ CANVAS BACK ROAD)	FROM SR1250 (OAK TREE ROAD) TO SR1179 EXCEPTING BRAWLEY SCH RD. INTERSECTION	2,3,4,5	2	NO	NO	2.79	20-75	980	279	5.15	9,750	180			4,400	300	298	300		3	1	1,134	250	*
		TOTAL FOR PROJ NO. 49861.3.2						3.93			1,360	329	7.43	9,750	255	850	550	4,400	300	399	450	1	4	2	1,458	350	1
		GRAND TOTAL						3.93			1,360	329	7.43	9,750	255	850	550	4,400	300	399	450	1	4	2	1,458	350	1

PROJECT NO.	SHEET NO.	TOTAL NO.
49861.3.1		

THERMOPLASTIC AND PAINT QUANTITIES

PROJECT NO	COUNTY	MAP NO	ROUTE	DESCRIPTION	TYP NO	LANES	LENGTH		WIDTH	4400000000-E	4457000000-N	4685000000-E	4695000000-E	4709000000-E	4720000000-E				4725000000-E		4890000000-E		4905000000-N		
							WORK ZONE ADVANCE/GE NERAL WARNING SIGNING	TEMPORARY TRAFFIC CONTROL		THERMO LINES YELLOW (4", 90 MILS)	THERMO LINES WHITE (8", 90 MILS)	THERMO LINES WHITE (24", 90 MILS)	THERMO MSG ONLY 90 M	THERMO MSG SCHOOL 90 M	THERMO LT ARROW 90 M	THERMO STR & RT ARROW 90 M	THERMO RT ARROW 90 M	THERMO STR ARROW 90 M	HOT SPRAY THERMO LINES WHITE (4", 50 MILS)	HOT SPRAY THERMO LINES YELLOW (4", 50 MILS)	SNOW PLOWABLE MARKERS				
							MI	FT	SF	LS	LF	LF	LF	EA	EA	EA	EA	EA	EA	EA	EA	EA	EA		
49861.3.2	Iredell	1	SR1359 (BRISTOL DRIVE)	FROM NC90/US64 TO US70	1	2	1.14	18-20	130	*			40			2	2					11,750	11,750	10	
49861.3.2	Iredell	2	SR1179 (OAK TREE/ CANVAS BACK ROAD)	FROM SR1250 (OAK TREE ROAD) TO SR1179 EXCEPTING BRAWLEY SCH RD. INTERSECTION	2,3,4,5	2	2.79	20-75	335	*	60	175	550	8	12	9	2	12	2			30,750	29,500	100	
TOTAL FOR PROJ NO. 49861.3.2								3.93		465	1	60	175	590	8	12	11	4	12	2			42,500	41,250	110
GRAND TOTAL								3.93		465	1	60	175	590	8	12	11	4	12	2			42,500	41,250	110
														20		29						83,750			

SIGNING FOR RESURFACING PROJECTS

LEGEND

┆ STATIONARY SIGN

← DIRECTION OF TRAFFIC FLOW

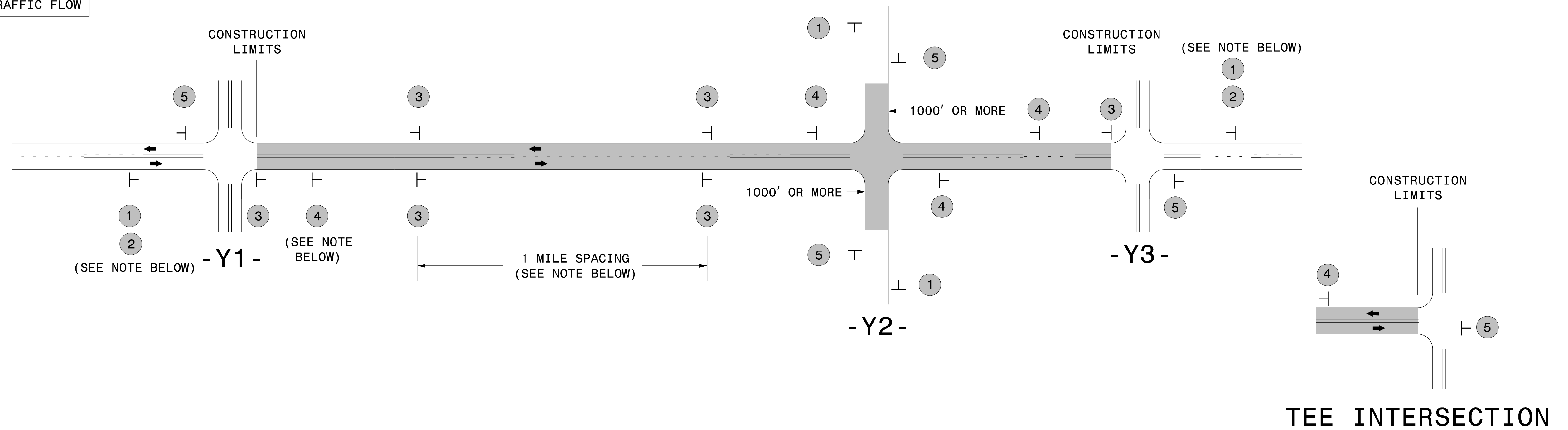

MAINLINE (-L-) SIGNING

-Y- LINE SIGNING

SIGNING NOTES AND PLACEMENT PER DIRECTION	1	 W20-1 48" X 48"	PLACE 1000' PRIOR TO BEGINNING OF CONSTRUCTION LIMITS. ONLY USED ON -Y- LINES IF RESURFACING LIMITS EXTEND 1000' ALONG -Y- LINE.	<p>NO REQUIRED STATIONARY SIGNING FOR THE FOLLOWING -Y- LINE CONDITIONS:</p> <ol style="list-style-type: none"> 1) LESS THAN 1000' OF RESURFACING ALONG -Y- LINE 2) SUBDIVISION ROADS 3) DEAD END ROADS <p>WHEN PAVING/CONSTRUCTION ACTIVITIES PROCEED ACROSS AN UNSIGNED -Y- LINE, PORTABLE ADVANCE WARNING SIGNS SHALL BE USED ALONG THE -Y- LINE AS SHOWN BELOW. REMOVE UPON COMPLETION OF WORK.</p> <div style="display: flex; justify-content: space-around;"> <div style="text-align: center;"> W20-1 48" X 48" PLACED 500' IN ADVANCE OF FLAGGER. </div> <div style="text-align: center;"> W20-7 A 48" X 48" PLACED 250' IN ADVANCE OF FLAGGER. </div> </div>
	2	 NEXT XX MILES W7-3aP 24" X 18"	#2 SIGN ONLY USED WHEN CONSTRUCTION LIMITS ARE 2 OR MORE MILES IN LENGTH. ROUND UP TO NEXT WHOLE NUMBER. (NO FRACTIONAL OR DECIMAL NUMBERS)	
	3	 LOW/SOFT SHOULDER SP 13107 48" X 48"	<ul style="list-style-type: none"> - PLACE INITIALLY AT THE CONSTRUCTION LIMITS AND SPACE 1 MILE APART THEREAFTER. - AT TEE INTERSECTIONS INSTALL INITIALLY 1/2 MILE FROM INTERSECTION AND SPACE 1 MILE APART THEREAFTER. 	
	4	 ROAD UNDER CONST SP 13106 48" X 48"	<ul style="list-style-type: none"> - THESE ARE FOR -Y- LINES THAT ARE "THROUGH" ROADWAYS. - DEAD END AND SUBDIVISION ROADS ARE NOT "THROUGH" ROADWAYS. - INSTALL 500' +/- FROM EACH -Y- LINE APPROACH AS SHOWN ABOVE. - FOR MULTIPLE -Y- LINES THAT ARE SEPARATED BY 0.25 MILES OR LESS, TREAT AS A SINGLE UNIT AND INSTALL WITHIN 500' OF EACH APPROACH. - A MAXIMUM OF 2 SIGN SETS PER MILE. DO NOT INSTALL WHEN -Y- LINES ARE WITHIN 0.5 MILES FROM "END ROAD WORK" SIGN. - FOR TEE INTERSECTIONS, INSTALL WITHIN 500' +/- OF THE INTERSECTION ALONG -L- LINE. 	
	5	 END ROAD WORK G20-2 A 48" X 24"	PLACE 500' FOLLOWING THE END OF CONSTRUCTION LIMITS OR AS SHOWN WHEN WORK ENDS AT A 3-WAY TEE INTERSECTION.	

THE ABOVE SIGNS ARE ALL THAT ARE REQUIRED FOR A CONTRACTOR TO BEGIN A RESURFACING CONTRACT. ANY ADDITIONAL SIGNS REQUESTED BY NCDOT DIVISIONS SHALL BE INSTALLED WITHIN 7 BUSINESS DAYS OF THE START OF CONTRACT WORK.

MAPS LESS THAN 2 MILES

FOR RESURFACING MAPS WITH CONSTRUCTION LIMITS LESS THAN 2 MILES IN LENGTH, NO STATIONARY SIGNS ARE REQUIRED. USE PORTABLE "ROAD UNDER CONSTRUCTION" OR "ROAD WORK AHEAD" SIGNS IN LIEU OF STATIONARY ADVANCE WARNINGS SIGNS.

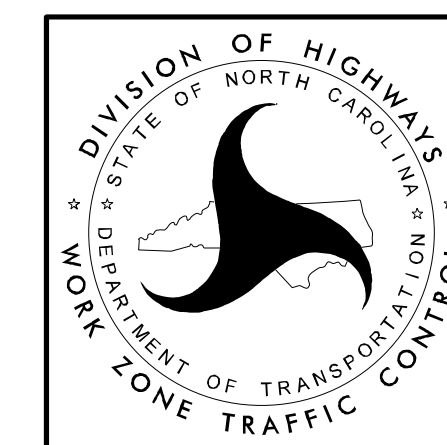

ADVANCE WARNING SIGNS FOR RURAL AND SUBURBAN 2-LANE ROADWAY RESURFACING